

Fountainne Pajot MY5



Dužina Preko Svega:

12.20 m

Širina:

5,96 m

Model Godina:

2022

Motorizacija:

**2 x Volvo Penta IPS600 D6-440 (2
x 440 KS)**

Kabine:

3

Ležajevi:

6

Kupaonice:

2

Spremnik Za Vodu:

450 l + 40 l

Spremnik Za Gorivo:

2 x 700 l

CIJENA:

780.000 €**Bez PDV-a**

Oprema

Opća oprema: • Antifouling • Sidro • Spremište za sidro • Sustav za pranje palube • Vrata -kokpit/platforma • Ljestve za kupanje • Krmena platforma • Pasarela • Tikovina na platformi za kupanje • Stol u kokpitu • Pramčani jastuci • Jastuci u kokpitu • Hladnjak na Flybridge-u • Ledomat • Radio • Sef • Zvučnici u kokpitu

Raspored interijera: • Kormilo • Kormilo na Flybridge-u • Flybridge • Salon • Vlasnička kabina • Kabina za goste • Krmena kabina

Električna oprema: • Klimatizacijski uređaj • Generator • Inverter • Baterije • Punjač baterija • Kaljužna pumpa • Kopneni priključak za struju

Navigacijska oprema: • Autopilot • Autopilot sa repeater-om • Kompas • Kompas s repeater-om • Dubinomjer • Dubinomjer sa repeater-om • GPS navigacija • Joystick upravljač • Brzinomjer • VHF Radio

Kuhinjska oprema: • Keramička ploča za kuhanje • Perilica za suđe • Sudoper • Električni roštilj • Refrigerator • Zamrzivač • Mikrovalna/pećnica (kombinirani aparat) • Pećnica • Hladnjak za vino

Kupaonica/WC: • Vlasničko kupatilo • Kupaonica za goste • Kupaonica • Tuš • Toilet • Električni WC • Sudoper

Pokrivala/tende: • Bimini (tenda)

This very well equipped Fountaine Pajot MY5 for sale.

Special equipment:

Gold Version - Package

- Windlass control & chain counter on fly bridge
 - Outdoor cockpit & fly cushions
 - Front saloon pleated blinds
 - One fresh water electric head on portside (owner's head)
 - Main grid 220V 50HZ or 220V 60HZ
 - Outdoor foredeck cushions
 - Inside & outside courtesy lighting
 - Hot water on deck shower
 - 3000W 70A charger inverter
 - Pressurized seawater system (anchor locker & cockpit)
-
- Volvo IPS 600 pack, 2 joysticks, twin go filters & fixed fire extinguishing system
 - Bimini hard top on fly bridge
 - Cockpit sun awning
 - Dralon protective cover for fly helm station
 - Exterior window blinds for saloon
 - Removable cockpit table
 - Diner table on fly
 - Kitchen furniture on flybridge
 - Handrails on fore deck accesses
 - 2 capstans in cockpit
 - Fridge on flybridge
 - 220V Kenyon electric grill on flybridge
 - Underwater lighting
 - Electric saloon coffee table convertible into a dinner table
 - Anchor locker & cockpit freshwater outlet
 - Combination locking safe
 - Mosquito nets for cabin portholes
 - Synthetic teak floor in maestro shower
 - Hull bed slated bases
 - GARMIN 2 Smart Cruising: IPS pilot, AIS VHF & 2x GPSMAP 12"
 - GARMIN aft camera
 - GARMIN autopilot remote control
 - BOSE audio video (tuner DVB-T) for saloon, cockpit & fly
 - Combined fridge & - 5°C cold Storage (160l/60l)
 - 2 induction hobs
 - Combination microwave oven
 - Dishwasher for 6 pers.
 - 5kg washing machine

- Wine cellar for 23 bottles
- Icemaker
- One fresh water electric head on starboard side
- 2nd 40 liter water heater
- Solar panels (3x 100W)
- Generator 8kW
- Full boat air cond. system 40 000BTU
- Air conditioning shore connection
- Aft hydraulic platform & natural teak (up to 400kg)
- Antifouling
- Double seat at the fly helm station
- Search light (2 controls)

Errors and changes excepted.

Glavna paluba



Glavna paluba

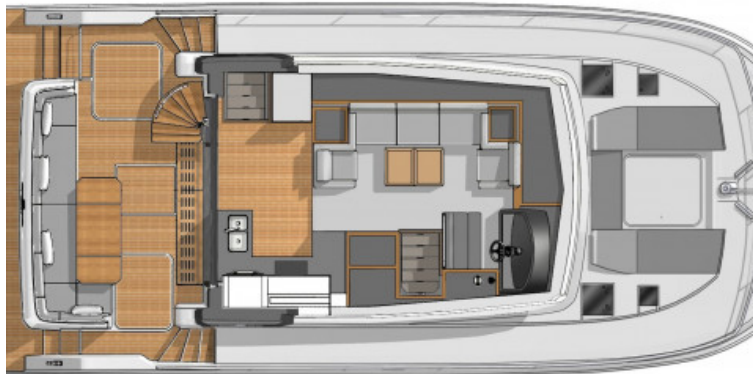

Donja paluba









